

HISTORIC RESOURCE SURVEY FORM
University of Oregon Cultural Resources Survey
Eugene, Lane County, Oregon
Summer 2006, Updated 2025

RESOURCE IDENTIFICATION

Current building name: Klamath Hall

Historic building name: Science II

Building address: 1370 Franklin Blvd.

Ranking: Non-Contributing

ARCHITECTURAL DESCRIPTION

Architectural style classification: Brutalist

Building plan (footprint shape): Rectangular

Number of stories: 4 stories plus a basement

Foundation material(s): Poured concrete

Primary exterior wall material: Poured concrete

Secondary exterior wall material: Metal panels below windows

Roof configuration/type: Flat

Primary roof material: Built-Up Roof

Primary window type: Fixed

Primary window material: Metal

Decorative features and materials: Exposed poured concrete structural frame

Landscape features: Science Courtyard with light well at center, bike racks, Streisinger Courtyard to the east

Associated resources: Attached to Onyx Bridge, Willamette Hall and Streisinger Hall; Basement Science Library

Comments: Klamath Hall is a rectangular structure whose dominant visual feature is the expressed structural frame. The metal windows are set back several feet from the frame.

ARCHITECTURAL HISTORY

Date of construction: 1967

Architect: Skidmore, Owings, and Merrill

Builder/Contractor: W.S. Hardie and Sons

Moved? (yes/no): No Date of move(s): N/A

Description/dates of major additions/alterations: Klamath Hall has been periodically remodeled on its interior. Most of these remodels have updated the systems within individual laboratories. The most significant change to the building is the attachment of Willamette Hall to the southern entry façade and Streisinger Hall on the northeastern edge in 1989. In addition, the Science Library light well was altered in 1999 and in 2015 it was substantially diminished when the Price Science Commons, designed by Opsis, was constructed. Refer to Continuation Sheet 1 for details on specific alterations.

HISTORICAL ASSOCIATIONS & SIGNIFICANCE

Original use(s) or function(s): Science Classrooms

Current use(s) or function(s): Science Classrooms

Area(s) of significance: Education, Architecture

Period of significance: 1967

Statement of Significance (use continuation sheet if necessary):

The science departments at the University of Oregon continued to grow in enrollment and specialization during the late 1950s and early 1960s. By the mid 1960s, the facilities in Science I (Pacific Hall) and its East Addition(Onyx Bridge) were cramped and outdated. Emerging fields such as Molecular Biology needed space and specialized equipment. The University planned to augment the science facilities with new buildings. In addition to funding from the State of Oregon, much of the sponsorship for individual laboratories came from grants given by the National Science Foundation and National Institutes of Health.

The selection of Skidmore, Owings, and Merrill (SOM) to conduct the master planning for the science complex and design for Science II is significant in that this was the first firm from outside of the Northwest to design a campus building. This large, international firm is known for technically sophisticated buildings that emphasize utility. The master plan for the science complex called for incremental building with separate structures linked by corridors and courtyards to provide unity. The functional requirements of the departments housed within provide the organizational scheme for each individual building. The design for Klamath Hall (Science II) utilizes modern design principles to respond to the ever-changing functional needs. In keeping with Modernist principles, the only ornament is the expression of the structural frame. Not merely an aesthetic choice, the frame and corresponding lack of internal columns provides for open laboratory spaces, easy internal partitioning, and sun control. The use of fixed windows and reliance on mechanical ventilation also reflect the importance of technology in modern design. The desire to maximize internal flexibility drove the decisions for everything from mechanical systems to laboratory finishes. The Science Library's central location is a hub linking the various departments together. The Library's position in the basement maximizes the coverage on the site with the light well providing daylight and controlled access to the outdoors from within the facility. The Library is emblematic of the connection between utility and technology found throughout Klamath Hall and modern design. . The Science Library light well was altered in 1999 to address leakage problems. In 2016 it was substantially diminished in size when the Allan Price Science Commons and Research Library, designed by Opsis, was constructed on top of the light well. The library was named for Allan Price, a former UO Vice President.

Science II has been an important center for scientists at the University of Oregon since 1967. Interior alterations and updates to the building have kept the facilities current with the latest in technical requirements. The connection of Willamette Hall and Streisinger Hall in 1989 dramatically changed the building. The entry experience and the character of the front elevation are particularly altered although structurally intact. In 1990 the building was renamed Klamath Hall for the Klamath people. Klamath currently houses facilities for Biology and Chemistry.

The design of Klamath Hall emphasized technology and utility. Although designed by a prominent architect, it is not a notable example of their work or of the Brutalist style. The periodic internal remodels are consistent with the design intention to accommodate changing functional requirements. These alterations have not changed the essential form or character of the building. The connection of Willamette Hall and Streisinger Hall in 1989, however, dramatically changed the building. Also, the Science Library light well has been notably altered. The loss of integrity from these additions and alterations combined with its low to very low significance compared to other campus buildings gives Klamath Hall its non-contributing status.

NATIONAL REGISTER ELIGIBILITY ASSESSMENTHistoric Significance (check one): High Medium Low Very Low or NoneIntegrity (check one): Excellent Good Fair PoorCondition (check one): Excellent Good Fair PoorBuilding designation: City Landmark National Register National Historic Landmark Not listedPreliminary National Register eligibility findingsBuilding is potentially eligible: Individually or As a contributing resource in a district only

If eligible individually, applicable criteria (check all that apply):

- A. Associated with significant events C. Distinctive architecturally
 B. Associated with significant persons D. Archaeologically important

If applicable, building qualifies under NR Criterion Considerations: Yes No If yes, which apply:Building is NOT eligible: Intact but lacks distinction or Altered/loss of integrity or Not 50 years old

DOCUMENTATION

Indicate resources consulted when researching this building (check all that apply):

- | | | |
|---|--|---|
| <input checked="" type="checkbox"/> University archives | <input checked="" type="checkbox"/> UO Planning Office files | <input type="checkbox"/> Newspapers |
| <input type="checkbox"/> Sanborn maps | <input type="checkbox"/> Building permits | <input type="checkbox"/> SHPO files |
| <input type="checkbox"/> State Archives | <input type="checkbox"/> State Library | <input type="checkbox"/> State Historic Society |
| <input type="checkbox"/> Local Historic Society | <input type="checkbox"/> Personal interviews | <input type="checkbox"/> Historic photographs |
| <input type="checkbox"/> Biographical encyclopedias | <input type="checkbox"/> Obituary indexes | Other : <u>see below</u> |

BIBLIOGRAPHICAL REFERENCES*Building Proposals*

Skidmore Owings, and Merrill. *University of Oregon Science Building. Second Addition. Pre-preliminary Submittal.* University Planning Facilities Services Box 2 of 5, Special Collections, University of Oregon, Eugene. 1964.

University of Oregon Science Building Second Addition Preliminary Submittal. University Planning Facilities Services Box 2 of 5, Special Collections. University of Oregon, Eugene. 1964.

Guides

Teague, Edward. *The Architecture of the University of Oregon A History, Bibliography, & Research Guide.* Eugene, OR: University of Oregon, 2004-2005.

Klamath Hall Building Plans. Facilities Services, University of Oregon, Eugene.

Letters

Mohr, Fed to James B. Hall, editor Chemical and Engineering News 11 April 1966. University Planning Facilities Services Box 3 of 5. Special Collections, University of Oregon, Eugene.

University of Oregon Facilities Services Manuals

University of Oregon Facilities Services. *Specification for University of Oregon Science II Building New Laboratory Spaces.* Facilities Services, University of Oregon, Eugene. 1968.

Project Manual *Organic Chemistry and Molecular Biology Unfinished Spaces Science Building 2nd Addition.* Facilities Services, University of Oregon, Eugene. 1970.

Project Manual Mechanical, Plumbing, Heating, & Ventilation for Molecular Biology Laboratories Second Addition, Phase 2. Facilities Services, University of Oregon, Eugene. 1970.

Project Manual Specifications for University of Oregon Science Building Second Addition Remodel. Facilities Services, University of Oregon, Eugene. 1971.

Refer to Continuation Sheet 1

RECORDING INFORMATION

Researched: Jennifer L. Flathman, Erin Pochert, 01/02/2006

Recorded: Susan Johnson and University Planning Office, Summer 2006

Photo number or name: Klamathcropped.jpg

PHOTOGRAPH



SITE PLAN

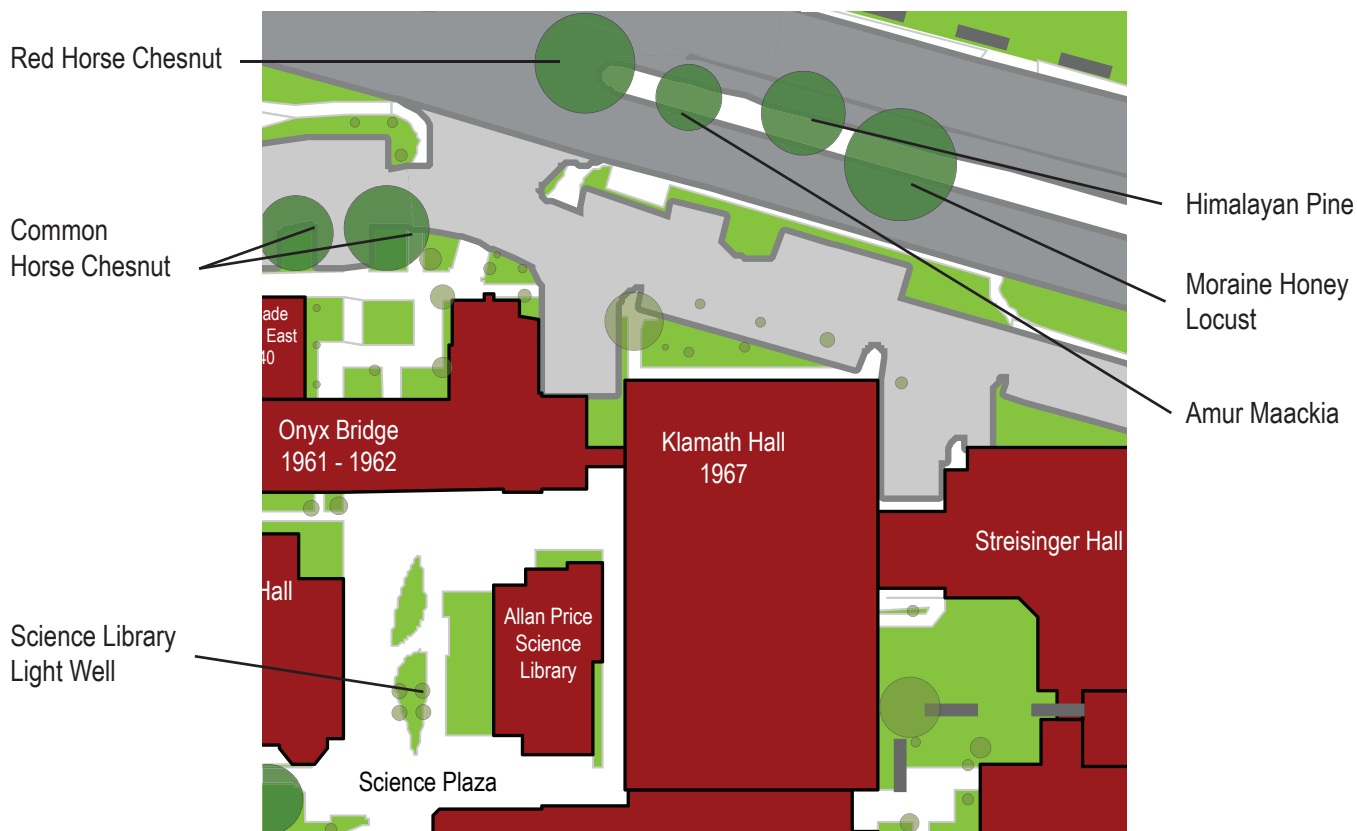

HISTORIC RESOURCE SURVEY FORM

University of Oregon Cultural Resources Survey
Eugene, Lane County, Oregon
Spring 2006, Updated 2025

Continuation Sheet 1**Section Bibliography Page 2**

Klamath Hall Building Plans. Facilities Services, University of Oregon, Eugene.

Project Manual Science Room 120/168 Improvements. Facilities Services, University of Oregon, Eugene. 1981.

Project Manual Science II Room 120 Fire Dampers. Facilities Services, University of Oregon, Eugene. 1981.

Project Manual Science II Electron Microscope Room Ventilation. Facilities Services, University of Oregon, Eugene. 1981.

Project Manual Rooms 168/120 –A Ventilation Improvements. Facilities Services, University of Oregon, Eugene. 1982.

Project Manual Building No 38 Science II BPA Institutional Buildings Program. Facilities Services, University of Oregon, Eugene. 1986.

Project Manual Building No. 38 Science II US Department of Energy Institutional Conservation Program. Facilities Services, University of Oregon, Eugene. 1986.

Project Manual Science Library Asbestos Abatement. Facilities Services, University of Oregon, Eugene. 1987.

Project Manual Science II Courtyard Repair Project. Facilities Services, University of Oregon, Eugene. 1989.

Project Manual Klamath Hall Basement Repairs. Facilities Services, University of Oregon, Eugene. 1992.

Project Manual Klamath Hall 323/327 Organic Chemistry Lab Remodel. Facilities Services, University of Oregon, Eugene. 2000.

Project Manual Klamath Hall Labs 245-255. Facilities Services, University of Oregon, Eugene. 2001.

Project Manual Klamath Hall Phase 2 Green Lab. Facilities Services, University of Oregon, Eugene. 2002.

Project Manual Klamath Hall Sprinkler Protection. Facilities Services, University of Oregon, Eugene. 2002.

Project Manual Phase I Semi-conductor Training Lab. Facilities Services, University of Oregon, Eugene. 2002.

Project Manual Science Library Plaza Repair. Campus Facilities Services, University of Oregon, Eugene. 2003.

Project Manual Klamath Hall Lonergan Lab Remodel. Facilities Services, University of Oregon, Eugene. 2003

University of Oregon Science Buildings Additions and Alteration: A Manual for Prospective Architectural Consultants November 1984.
University Planning Facilities Services Box 3 of 5. Special Collections. University of Oregon, Eugene.