

HISTORIC RESOURCE SURVEY FORM
University of Oregon Cultural Resources Survey
Eugene, Lane County, Oregon
Summer 2006, Updated 2025

RESOURCE IDENTIFICATION

Current building name: Columbia Hall
Historic building name: Geology Building
Building address: 1215 East 13th Avenue
Ranking: Tertiary

ARCHITECTURAL DESCRIPTION

Architectural style classification: Academic Vernacular
Building plan (footprint shape): irregular
Number of stories: 2
Foundation material(s): concrete
Primary exterior wall material: brick
Secondary exterior wall material: mosaic ceramic tile
Roof configuration/type: flat
Primary roof material: BUR
Primary window type: two parallel casements over horizontal hopper
Primary window material: metal
Decorative features and materials: belt course, basalt sculpture at south loggia; Also, see Comments
Landscape features: perimeter plantings, Science Walk with decorative brick design at northeast corner; Also, see Comments
Associated resources: Pacific Hall and Science Walk at northeast corner, 13th Ave Axis, and University Street Axis
Comments: Additional decorative features include the granite wall of south lobby, two brick posts at the south loggia and mosaic tile along north facade. Additional landscape features include six brick and concrete planter boxes and gridded concrete pattern of patio space along the south and west sides of the building. There are metal pipe railings along the light wells on the east and south sides.

ARCHITECTURAL HISTORY

Date of construction: 1960
Architect: Lawrence, Tucker and Wallmann Architects
Builder/Contractor: Cooper and Rose and Associates; J. Donald Kroeker and Associates; Grant Kelley and Associates; L.H. Morris Electric Company; and Vik Construction Company
Moved? (yes/no): No Date of move(s): N/A
Description/dates of major additions/alterations: Miscellaneous interior remodeling over the life of the building, including room remodeling in 1963, 1966, 1969, 1970, 1971, 1974, 1976, 1982, 1983, 1990, 1991, and 1996, Science Walk installed in 1989; Classroom 150 remodeled in 2012.

HISTORICAL ASSOCIATIONS & SIGNIFICANCE

Original use(s) or function(s): Classrooms/Offices

Current use(s) or function(s): Classrooms/Offices

Area(s) of significance: Education, Architecture

Period of significance: 1960

Statement of Significance (use continuation sheet if necessary):

This building was built in 1960 as an extension of the growing science division on campus. Early reports show it to house the geology program, which had split from the geography program in 1958. While the creative writing program is currently housed in this building, interior exhibits and classroom configurations confirm its continued use by the geology department. This building also houses the largest lecture hall on the University of Oregon campus in the western portion (Room 150). The building plans refer to it as the south wing, or first addition of "Science One" which is the former name of Pacific Hall. Laboratory facilities were installed in all of the classrooms to accommodate use by the science departments. The former men's gymnasium occupied the site. Campus myth claims that the mosaic tiles from the swimming pool that was demolished were incorporated into the design on the north facade but there is no documentary evidence to confirm this rumor. The east facade and a portion of the south facade include basement level light wells, with simple, pipe metal safety railings. The south lobby's southern facade is a granite slab with glass doors on the east and west ends. The south loggia includes two brick posts and a basalt rock sculpture, by Steve Gillman, attached to the interior wall. Shrubbery is planted along the south, east and north facades. Trees are planted in planter boxes along the west side. It is three stories, including basement level, of classrooms and offices in the eastern portion. There is a belt course between the first and second floors along the eastern portion. All of the windows are metal vertical paired casements over a horizontal hopper. While mainly a freestanding brick building, it is connected to Pacific via a second story bridge on the north side. Decorative brick work is incorporated into the perimeter Science Walk sidewalk along the northeast corner. This is part of the "science walk" installed in 1982. The building is sited at the corner of University Street and 13th Avenue.

This building has limited significance. Given its excellent integrity but low significance relative to other campus buildings, it is ranked as a tertiary resource.

NATIONAL REGISTER ELIGIBILITY ASSESSMENTHistoric Significance (check one): High Medium Low Very Low or NoneIntegrity (check one): Excellent Good Fair PoorCondition (check one): Excellent Good Fair PoorBuilding designation: City Landmark National Register National Historic Landmark Not listedPreliminary National Register eligibility findingsBuilding is potentially eligible: Individually or As a contributing resource in a district only

If eligible individually, applicable criteria (check all that apply):

- A. Associated with significant events C. Distinctive architecturally
 B. Associated with significant persons D. Archaeologically important

If applicable, building qualifies under NR Criterion Considerations: Yes No If yes, which apply:Building is NOT eligible: Intact but lacks distinction or Altered/loss of integrity or Not 50 years old

DOCUMENTATION

Indicate resources consulted when researching this building (check all that apply):

- | | | |
|---|--|---|
| <input checked="" type="checkbox"/> University archives | <input checked="" type="checkbox"/> UO Planning Office files | <input checked="" type="checkbox"/> Newspapers |
| <input checked="" type="checkbox"/> Sanborn maps | <input type="checkbox"/> Building permits | <input type="checkbox"/> SHPO files |
| <input type="checkbox"/> State Archives | <input type="checkbox"/> State Library | <input type="checkbox"/> State Historic Society |
| <input type="checkbox"/> Local Historic Society | <input type="checkbox"/> Personal interviews | <input type="checkbox"/> Historic photographs |
| <input type="checkbox"/> Biographical encyclopedias | <input type="checkbox"/> Obituary indexes | Other : <u>See below</u> |

BIBLIOGRAPHICAL REFERENCES

The Architecture at the University of Oregon <http://libweb.uoregon.edu/guides/architecture/oregon/>

Daily Emerald. "Science Addition work started; total cost to be over 2 million." 5/17/1960, 1.

Facilities Services. "University of Oregon Building Records, Projects and Improvements." [CD-ROM] Eugene, OR: University of Oregon, 2006.

Lawrence, Tucker and Wallmann Architects. "Science Building - First Addition." Drawings. Portland, OR: Lawrence, Tucker and Wallmann Architects, March 1960.

Lawrence, Tucker and Wallmann Architects. "Science Building - First Addition, Reported As-Built." Drawings. Portland, OR: Lawrence, Tucker and Wallmann Architects, October 1960.

Lawrence, Tucker and Wallmann Architects. "Science Building - First Addition." Specifications and Contract. Portland, OR: Lawrence, Tucker and Wallmann Architects, May 1960.

Old Oregon. Eugene, OR: University of Oregon Alumni Association, April-May 1960.

Old Oregon. Eugene, OR: University of Oregon Alumni Association, June-July 1958.

Oregana. Eugene, OR: University of Oregon, 1960.

Oregana. Eugene, OR: University of Oregon, 1975

Pigger's Guide. . Eugene, OR: University of Oregon, 1960-61.

Pigger's Guide. . Eugene, OR: University of Oregon, 1961-62.

Sanborn Map Company, Sanborn Library, LLC. Digital Sanborn Maps. ProQuest Information and Learning Company, 2001.
Accessed 26 February 2006 from <http://0-sanborn.umi.com.janus.uoregon.edu:80/or/7358/dateid-000001.htm>.

(See Continuation Page 1)

RECORDING INFORMATION

Researched: Kathleen Mertz, Elise Mendonca, Winter 2006

Recorded: Susan Johnson and University Planning Office, Summer 2006

Photo number or name:

PHOTOGRAPH



SITE PLAN

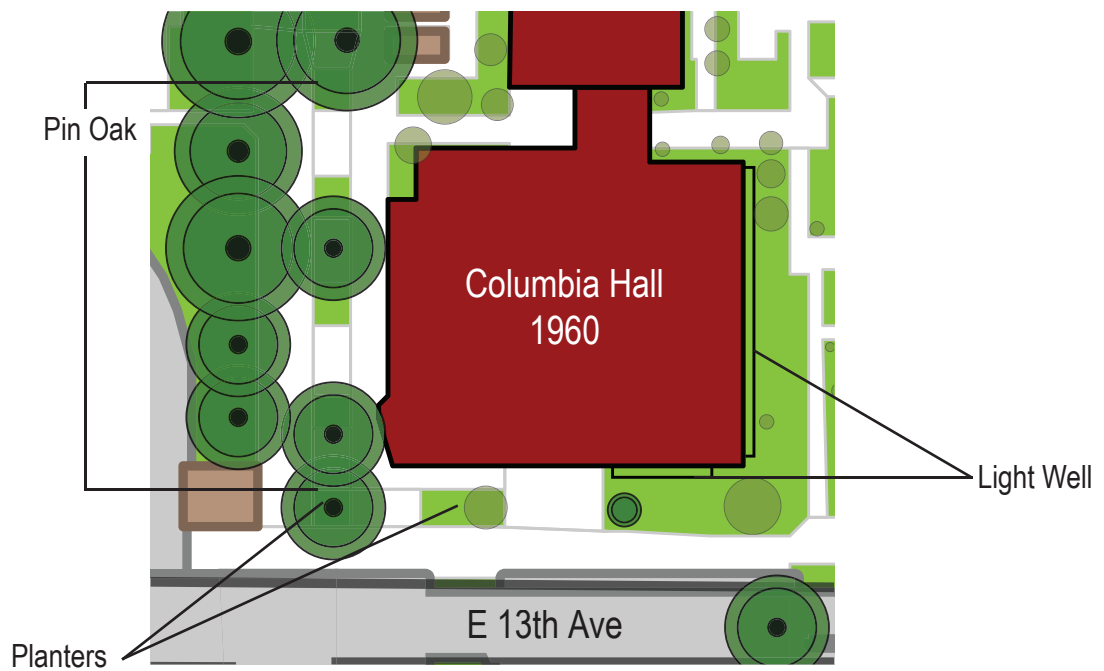

HISTORIC RESOURCE SURVEY FORM

University of Oregon Cultural Resources Survey

Eugene, Lane County, Oregon

Spring 2006, Updated 2025

Continuation Sheet 1**Section Bibliography Page 3**

University of Oregon 125th Anniversary <http://anniversary.uoregon.edu/tour/collier.html>

University Planning Office. "Getty Foundation Campus Heritage Grant 2005. Eugene, OR: University of Oregon, 2005.

University Planning Office. University of Oregon Northeast Central Campus Diagnosis. Eugene, OR: University of Oregon, 1999.

Wright, Sally and Pinyerd, David. Eugene Modernism 1935-1965. Eugene, OR: Eugene Planning and Development, 2003.