

Intent: Concentrate development proximate to existing and planned infrastructure; allow for additional open space between the Millrace Outfall and development; allow for potential to preserve vernal pools.

Vehicular Access and Parking: Surface parking to rear or side of building, along train tracks. No independent parking structure allowed.

Maximum Building Height: 45 feet
Maximum Building Coverage: 18%

Intent: Protect the river's edge; allow for restoration and laying back the bank, research, outdoor teaching, passive recreation, and river access.

Maximum Building Height: N/A

Intent: Accommodate future needs for physical education and recreation fields and support facilities in location that maximizes potential for other open space improvements; enable expansion and restoration of riparian fringe along river.

Vehicular Access and Parking: Restricted vehicle access. Parking limited to service, loading, and ADA.

Maximum Building Height: 15 feet
Maximum Building Coverage: 2%
Maximum Field Coverage: 50%

Intent: Concentrate university development proximate to existing and planned infrastructure; potential to preserve and restore remnant oak savannah; allow for possible displaced uses to be located here that may benefit from this location.

Vehicular Access and Parking: Restricted vehicle access. Parking limited to service, loading, and ADA.

Maximum Building Height: 45 feet
Maximum Building Coverage: 25%

LEGEND

	RIVERFRONT PARK SPECIAL AREA (S-RP) ZONE		ORDINARY HIGH WATER LINE
	CONSERVATION AREA		TOP OF BANK
	CAMPUS OPEN SPACE FRAMEWORK *		CONSERVATION AREA SETBACK (100-ft)
	DEVELOPMENT SITE **		BIKE PATH OPTIONS *
			TRAIL *
			VIEWPOINT *
			PADDLE CRAFT LAUNCH *
			AREA ID

NOTES

* General location

** Includes all site elements associated with permitted uses in the zone and regulating plan, such as but not limited to landscape, pathways, site furniture, transportation circulation, utilities, and public art.

Intent: Establish riparian conservation area as a key feature of the open-space framework and enable restoration of the Millrace. Uses limited to WR-Overlay, except development allowed on land prior developed.

Maximum Building Height: N/A

Intent: Allow for university and research park development similar to the rest of campus; extend campus and open-space framework across Franklin Boulevard; provide major connection to the river; concentrate development south of the railroad tracks.

Maximum Building Height: 85 feet
Maximum Building Coverage: Same as code allowance

Intent: Establish riparian conservation area as a key feature of the open-space framework and enable restoration of the Millrace. Uses limited to WR-Overlay, except development allowed on land prior developed.

Maximum Building Height: N/A

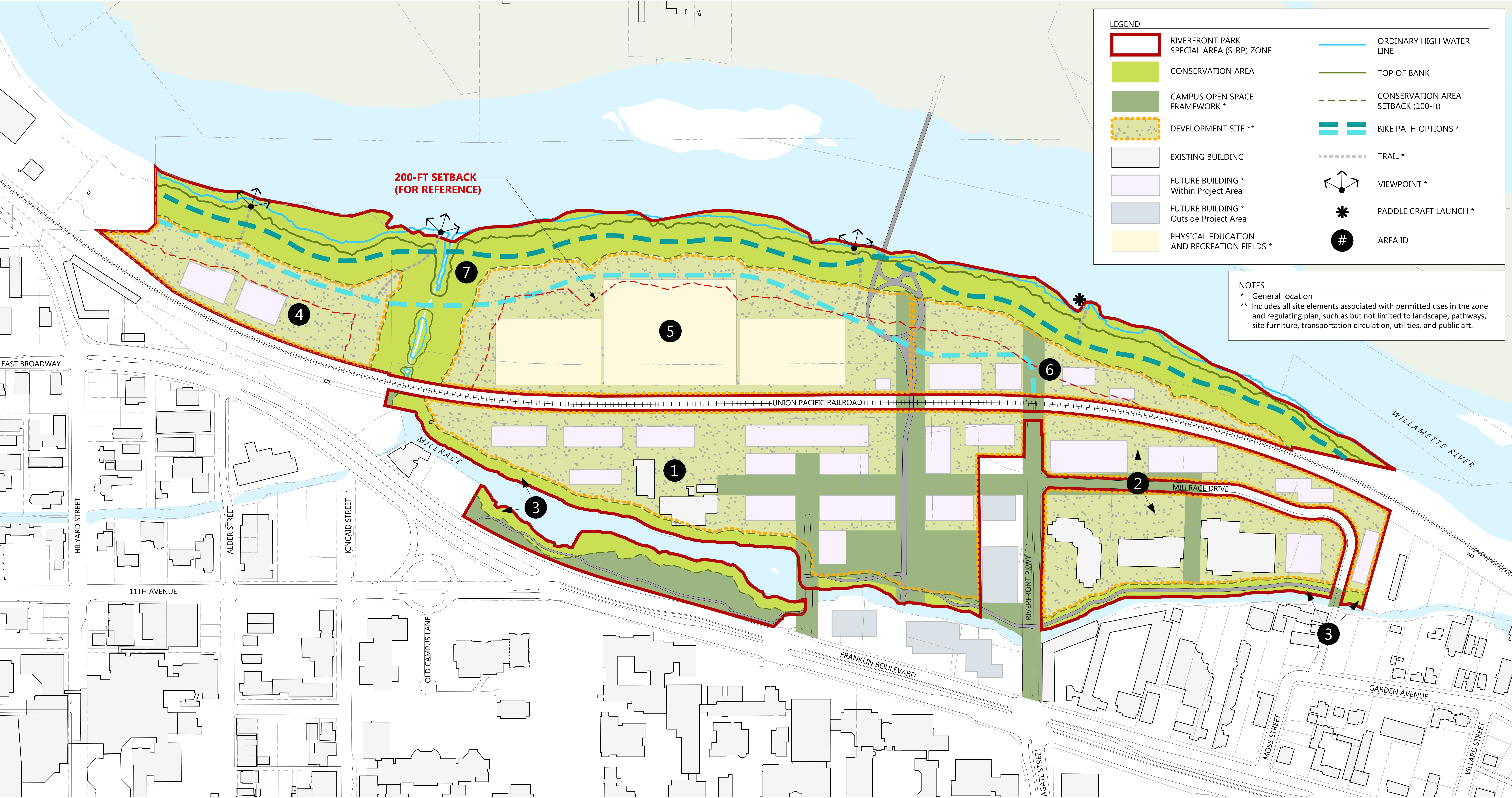

LEGEND

- | | | | |
|--|--|--|------------------------------------|
| | RIVERFRONT PARK SPECIAL AREA (S-RP) ZONE | | ORDINARY HIGH WATER LINE |
| | CONSERVATION AREA | | TOP OF BANK |
| | CAMPUS OPEN SPACE FRAMEWORK * | | CONSERVATION AREA SETBACK (100-ft) |
| | DEVELOPMENT SITE ** | | BIKE PATH OPTIONS * |
| | EXISTING BUILDING | | TRAIL * |
| | FUTURE BUILDING * Within Project Area | | VIEWPOINT * |
| | FUTURE BUILDING * Outside Project Area | | PADDLE CRAFT LAUNCH * |
| | PHYSICAL EDUCATION AND RECREATION FIELDS * | | AREA ID |

NOTES
* General location
** Includes all site elements associated with permitted uses in the zone and regulating plan, such as but not limited to landscape, pathways, site furniture, transportation circulation, utilities, and public art.

NOTES
 * General location
 ** Includes all site elements associated with permitted uses in the zone and regulating plan, such as but not limited to landscape, pathways, site furniture, transportation circulation, utilities, and public art.

LEGEND

	RIVERFRONT PARK SPECIAL AREA (S-RP) ZONE		ORDINARY HIGH WATER LINE
	CONSERVATION AREA		TOP OF BANK
	CAMPUS OPEN SPACE FRAMEWORK *		CONSERVATION AREA SETBACK (100-ft)
	DEVELOPMENT SITE **		BIKE PATH OPTIONS *
	EXISTING BUILDING		TRAIL *
	FUTURE BUILDING * Within Project Area		PEDESTRIAN / BICYCLE PRIMARY CIRCULATION
	FUTURE BUILDING * Outside Project Area		CROSSING
	PHYSICAL EDUCATION AND RECREATION FIELDS *		ACCESS POINT
			VIEWPOINT *
			PADDLE CRAFT LAUNCH *
			AREA ID

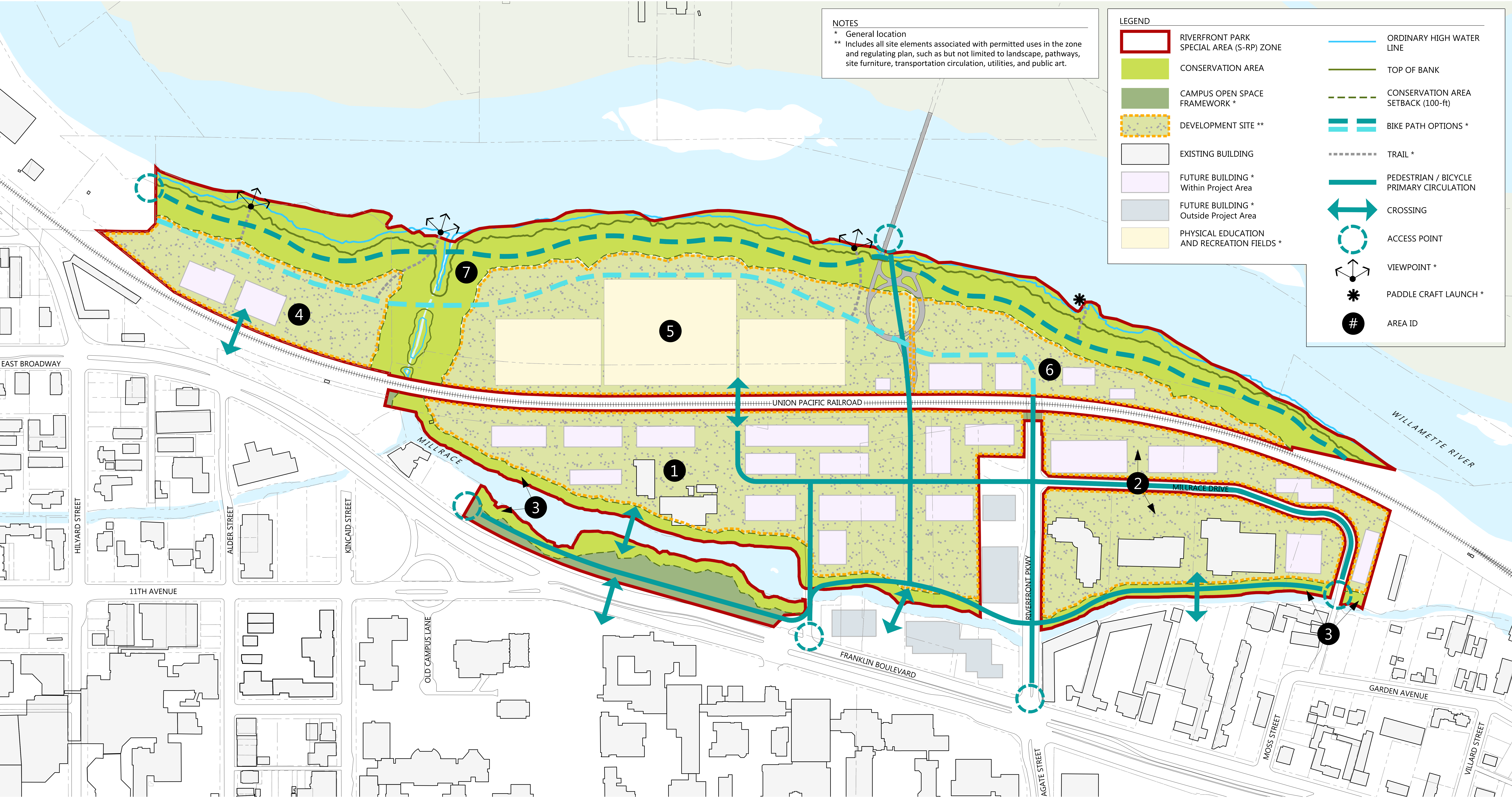

NOTES
* General location
** Includes all site elements associated with permitted uses in the zone and regulating plan, such as but not limited to landscape, pathways, site furniture, transportation circulation, utilities, and public art.

LEGEND

	RIVERFRONT PARK SPECIAL AREA (S-RP) ZONE		ORDINARY HIGH WATER
	CONSERVATION AREA		TOP OF BANK
	CAMPUS OPEN SPACE FRAMEWORK *		CONSERVATION AREA SETBACK (100-ft)
	DEVELOPMENT SITE **		BIKE PATH OPTIONS *
	EXISTING BUILDING		TRAIL *
	FUTURE BUILDING * Within Project Area		SERVICE VEHICLE PRIMARY CIRCULATION
	FUTURE BUILDING * Outside Project Area		CROSSING
	PHYSICAL EDUCATION AND RECREATION FIELDS *		ACCESS POINT
			VIEWPOINT *
			PADDLE CRAFT LAUNCH *
			AREA ID

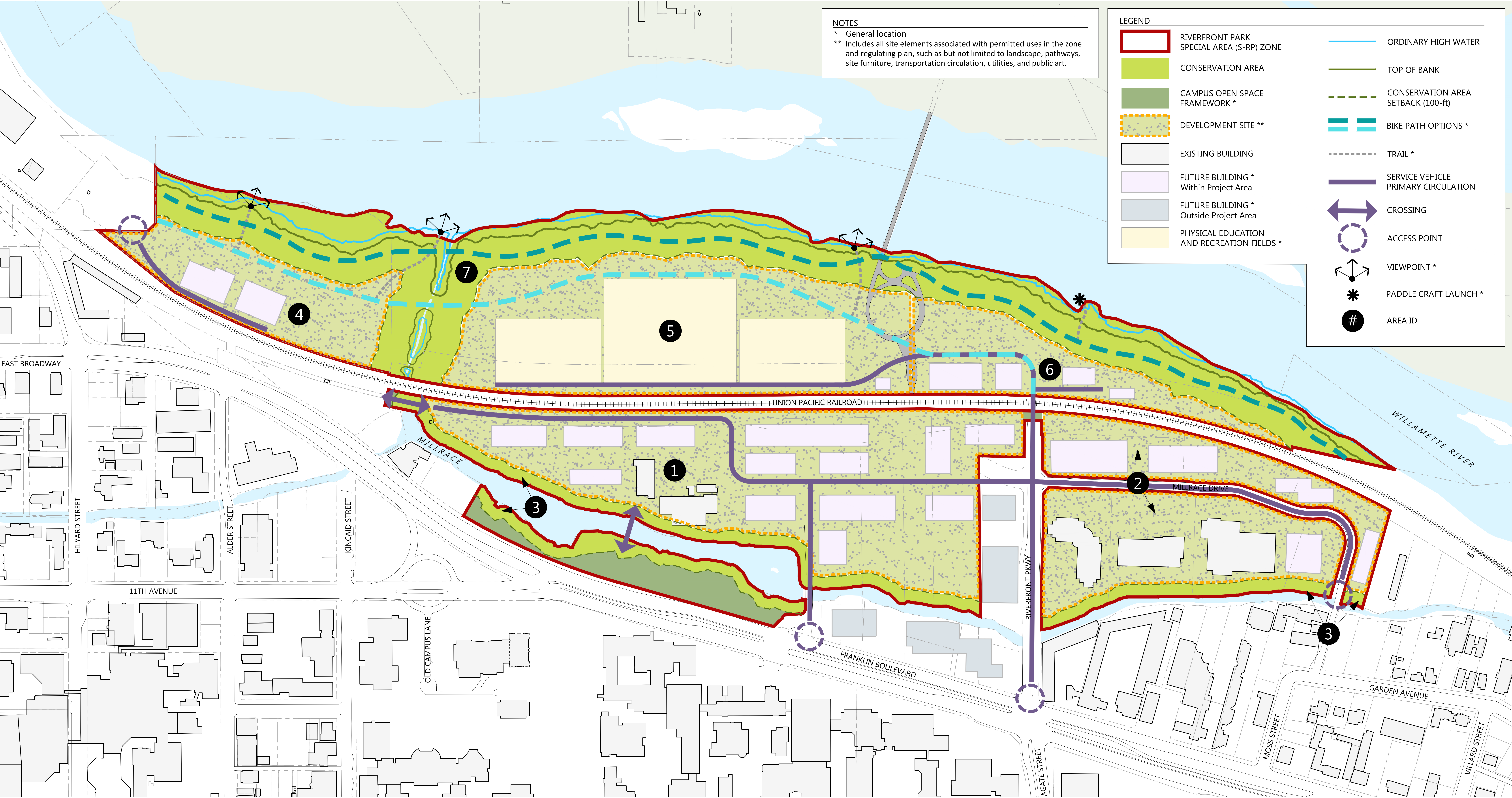

NOTES
* General location
** Includes all site elements associated with permitted uses in the zone and regulating plan, such as but not limited to landscape, pathways, site furniture, transportation circulation, utilities, and public art.

LEGEND

	RIVERFRONT PARK SPECIAL AREA (S-RP) ZONE		ORDINARY HIGH WATER LINE
	CONSERVATION AREA		TOP OF BANK
	CAMPUS OPEN SPACE FRAMEWORK *		CONSERVATION AREA SETBACK (100-ft)
	DEVELOPMENT SITE **		BIKE PATH OPTIONS *
	EXISTING BUILDING		TRAIL *
	FUTURE BUILDING * Within Project Area		PRIVATE VEHICLE PRIMARY CIRCULATION
	FUTURE BUILDING * Outside Project Area		MANAGED ACCESS
	PHYSICAL EDUCATION AND RECREATION FIELDS *		ACCESS POINT
			VIEWPOINT *
			PADDLE CRAFT LAUNCH *
			AREA ID

