

HISTORIC RESOURCE SURVEY FORM
University of Oregon Cultural Resources Survey
Eugene, Lane County, Oregon
Summer 2006

RESOURCE IDENTIFICATION

Current building name: Hamilton Hall Complex (East and West)

Historic building name: Hamilton Hall Complex (East and West)

Building address: East Complex/1364 Columbia Street, West Complex/1365 Agate Street

Ranking: Non-Contributing

ARCHITECTURAL DESCRIPTION

Architectural style classification: International

Building plan (footprint shape): radiating

Number of stories: 4

Foundation material(s): concrete

Primary exterior wall material: brick veneer

Secondary exterior wall material: aluminum panels

Roof configuration/type: flat

Primary roof material: elastic membrane

Primary window type: sliding industrial sash

Primary window material: aluminum

Decorative features and materials: black panels under windows for all sections; brick and hollow tile lattice work on McClain, Boynton, Collier, and Robbins sections of the complex; pink aggregate panels and lattice work on Dunn and Cloran

Landscape features: deciduous and evergreen trees and shrubs, foundation plantings, landscaped area to south ("Humpy Lumpy"), covered bike parking

Associated resources: It lies across Agate St. at the western terminus of the Promenade

Comments:

ARCHITECTURAL HISTORY

Date of construction: 1960-1961

Architect: Church, Newberry & Roehr

Builder/Contractor: unknown

Moved? (yes/no): no Date of move(s): N/A

Description/dates of major additions/alterations: 1995: dining area remodeled; 2000: new brick-enclosed service area facing north; 2001-02: dining area remodeled; 2004: reroofed

HISTORICAL ASSOCIATIONS & SIGNIFICANCE

Original use(s) or function(s): Dormitory

Current use(s) or function(s): Dormitory

Area(s) of significance: Architecture , Education

Period of significance: 1960-1961

Statement of Significance (use continuation sheet if necessary):

Built in two phases, Hamilton Hall is less than fifty years old and is an example of Modernist design ideas on the UO campus. It echoes specific International style examples in its design and construction, especially in the piloti on the Agate St. façade which resemble the arrangement of the ground floor of the Seagrams Building by Mies van der Rohe and Phillip Johnson, perhaps the most famous example of the International style. Other decoration include use of contrasting construction panels to create a sort of decorative checkerboard effect, the brick and hollow tile lattice work on McClain, Boynton, Collier, and Robbins units of the complex and the pink aggregate panels and lattice work on Dunn and Cloran units. Hamilton Hall's many semi-enclosed internal courtyards and common areas reflect Modernist ideas about reorganization of living space.

Hamilton was named for Judge James W. Hamilton, member of the Board of Regents and president from 1913-1925. The building consists of ten separate rectangular, 4 story units: Boynton, Cloran, McClain, Tingle, Spiller, Robbins, Dunn, Collier, Burgess, and Watson. Each unit is named for a former faculty member of the UO.

Hamilton Hall has good integrity. No discernible changes have been made to the fabric or design of the exterior. Interior changes have been limited to minor remodeling work and changes in use. Hamilton Hall may contribute to a campus historic district once it reaches 50 years of age as an example of Modernist architecture at the peak of its ascendancy and how it was applied to campus residential life. However, at this time Hamilton Hall is ranked as a non-contributing resource.

NATIONAL REGISTER ELIGIBILITY ASSESSMENTHistoric Significance (check one): ___ High ___ Medium ___ Low Very Low or NoneIntegrity (check one): ___ Excellent Good ___ Fair ___ PoorCondition (check one): ___ Excellent Good ___ Fair ___ PoorBuilding designation: ___ City Landmark ___ National Register ___ National Historic Landmark Not listedPreliminary National Register eligibility findings

Building is potentially eligible: ___ Individually or ___ As a contributing resource in a district only

If eligible individually, applicable criteria (check all that apply):

 A. Associated with significant events C. Distinctive architecturally B. Associated with significant persons D. Archaeologically important

If applicable, building qualifies under NR Criterion Considerations: ___ Yes ___ No If yes, which apply:

Building is NOT eligible: Intact but lacks distinction or ___ Altered/loss of integrity or Not 50 years old

DOCUMENTATION

Indicate resources consulted when researching this building (check all that apply):

- | | | |
|---|--|---|
| <input checked="" type="checkbox"/> University archives | <input checked="" type="checkbox"/> UO Planning Office files | <input type="checkbox"/> Newspapers |
| <input type="checkbox"/> Sanborn maps | <input type="checkbox"/> Building permits | <input type="checkbox"/> SHPO files |
| <input type="checkbox"/> State Archives | <input type="checkbox"/> State Library | <input type="checkbox"/> State Historic Society |
| <input type="checkbox"/> Local Historic Society | <input type="checkbox"/> Personal interviews | <input type="checkbox"/> Historic photographs |
| <input type="checkbox"/> Biographical encyclopedias | <input type="checkbox"/> Obituary indexes | Other _____ |

BIBLIOGRAPHICAL REFERENCES

Lutes and Amundsen, AIA. A Study of Dormitory Housing. Eugene, OR: University of Oregon, 1962.

Plans and Specifications for Hamilton Hall, Building Files, Facilities Services, University of Oregon.

Teague, Edward H. "Hamilton Hall." The Architecture of the University of Oregon. 10 Oct. 2004. 15 Mar 2005. University of Oregon Library. Eugene, OR. <<http://libweb.uoregon.edu/guides/architecture/oregon/>>

RECORDING INFORMATION

Researched: Shawn Lingo, Jeremy Mauro, February 2006

Recorded: Susan Johnson and University Planning Office, Summer 2006

Photo number or name:

PHOTOGRAPH



Hamilton Hall Complex, taken from northwest (corner of 13th and Agate Streets)
(See Continuation Sheet 1 for additional photos of this building)

SITE PLAN

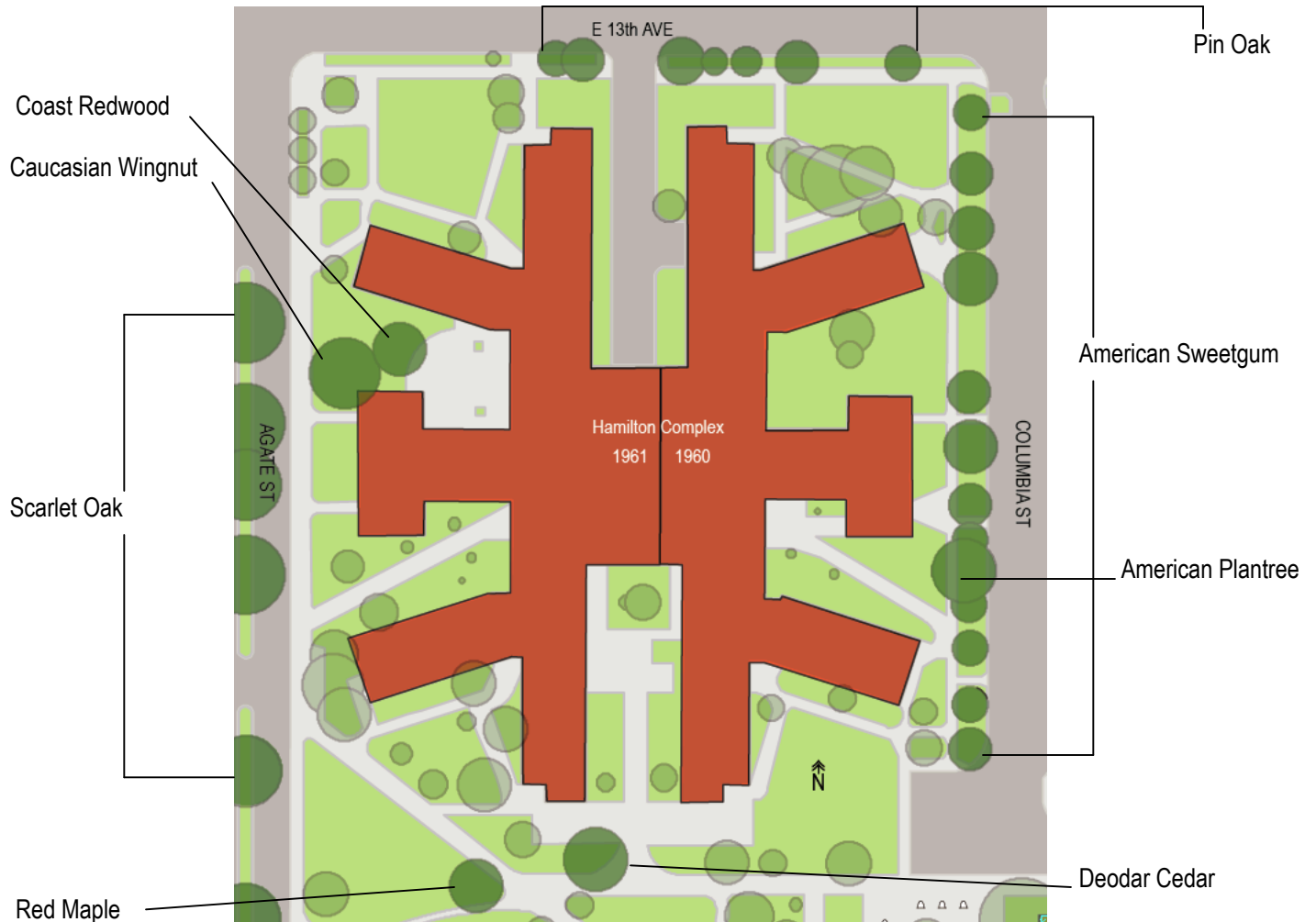

HISTORIC RESOURCE SURVEY FORM

University of Oregon Cultural Resources Survey
Eugene, Lane County, Oregon
Spring 2006

Continuation Sheet 1

Section _____ Photo _____ Page 4



Figure 2. Hamilton Hall. Dunn's endwall.



Figure 1. Hamilton Hall. Semi-enclosed courtyard.



Figure 3. Hamilton Hall's wooden marker